



PALACE HOTEL  
SAN FRANCISCO

THE  
LUXURY  
COLLECTION

ENCOUNTER THE LUXURY  
OF THE GILDED AGE,  
HISTORIC ARCHITECTURE  
AND WORLD-CLASS  
SERVICE AT THE PALACE  
HOTEL, A LUXURY  
COLLECTION HOTEL,  
SAN FRANCISCO.

---

#### HISTORY OF THE PALACE HOTEL

When it was originally established in 1875, the iconic Palace Hotel was the largest and most costly hotel in the world. On April 18, 1906 when the San Francisco earthquake hit, the building survived the quake structurally; however, the hotel was decimated in the ensuing fire that swept most of downtown San Francisco. The Palace Hotel re-opened its doors December 15, 1909, completely rebuilt after the devastation of the earthquake. The Palace Hotel has remained the landmark hotel in San Francisco with such timeless features as The Garden Court's stained glass dome with Austrian crystal chandeliers and the 1909 Maxfield Parrish painting of "The Pied Piper of Hamelin" located in the Pied Piper Bar.

#### DESTINATION

Located on the corner of Market and New Montgomery Streets, in the heart of San Francisco, the Palace Hotel is perfectly positioned for the Global Explorer's convenience. With our accommodating location, Union Square, Chinatown, the Financial District, and the Moscone Convention Center, business and shopping needs are never more than a few blocks away. Explore cultural and indigenous landmarks such as the San Francisco Museum of Modern Art, Yerba Buena Gardens, the Jewish Contemporary Museum, Museum of the African Diaspora and the Asian Art Museum, all within four blocks.



PALACE HOTEL  
A LUXURY COLLECTION HOTEL, SAN FRANCISCO  
2 NEW MONTGOMERY STREET, SAN FRANCISCO, CA94105 USA  
T 415 537 6347 - E MMSFO.METROLEADS@MARRIOTT.COM

SFPALACE.COM



**PALACE HOTEL**  
SAN FRANCISCO

**THE**  
**LUXURY**  
**COLLECTION**

	DIMENSIONS			CAPACITIES					
	AREA (M <sup>2</sup> )	SIZE (M)	CEILING HEIGHT (M)	THEATRE	CLASSROOM	U-SHAPE	RECEPTION	BANQUET	CONFERENCE
<b>LOBBY LEVEL</b>									
GRAND BALLROOM	2,732	33 x 25	5.5	1,000	550	–	1,000	720	–
ROSE	1,366	33 x 12.8	5.5	500	288	–	500	320	–
CONCERT	1,366	33 x 12.8	5.5	500	288	–	500	320	–
REGENCY FOYER	443	20.1 x 6.7	5.5	–	–	–	250	–	–
GOLD BALLROOM	1,508	29.6 x 15.5	5.5	550	300	–	600	400	–
RALSTON ROOM	1,613	33 x 15	5.2	600	300	–	600	420	–
<b>MEZZANINE</b>									
MONTGOMERY	195	12.2 x 4.9	2.6	–	–	–	–	–	18
SUTTER	200	10.5 x 5.8	2.6	–	–	–	–	–	16
GRANT	156	8.2 x 5.8	2.6	–	–	–	–	–	14
SACRAMENTO	195	9.4 x 6.4	2.6	50	26	–	50	30	22
<b>SECOND LEVEL</b>									
MENDOCINO	240	12.6 x 5.8	3	70	36	33	85	50	32
FRENCH PARLOR – UPPER	393	18.3 x 6.6	3.6	96	48	42	150	90	–
FRENCH PARLOR – LOWER	235	13.4 x 5.3	3.9	–	–	–	–	40	–
CALIFORNIA PARLOR	301	14.3 x 6.4	3	70	40	32	85	50	32
SIERRA	128	6.4 x 6.1	3	25	18	–	15	20	16
NAPA	208	10.7 x 6.1	3	60	30	26	75	50	28
SONOMA	161	8.2 x 6.1	3	50	25	18	75	50	24
MONTEREY	192	9.1 x 6.4	3	50	30	16	70	50	24
SEA CLIFF	436	13.4 x 9.9	3	140	72	36	150	120	40
PACIFIC HEIGHTS	396	12.2 x 9.9	3	120	72	36	135	100	34
MARINA	347	12.2 x 8.7	3	110	72	36	120	90	34
PRESIDIO	391	13.7 x 8.7	3	120	72	36	130	100	34
SUNSET COURT	1,578	33.6 x 12.8	7.3	300	–	–	600	220	–
TWIN PEAKS	927	23.8 x 11.9	4.4	300	175	72	330	240	64
TELEGRAPH HILL	386	9.9 x 11.9	3	120	72	36	130	100	34

PALACE HOTEL  
A LUXURY COLLECTION HOTEL, SAN FRANCISCO  
2 NEW MONTGOMERY STREET, SAN FRANCISCO, CA 94105 USA  
T 415 537 6347 – E MMSFO.METROLEADS@MARRIOTT.COM

SFPALACE.COM



**PALACE HOTEL**  
SAN FRANCISCO

**THE  
LUXURY  
COLLECTION**

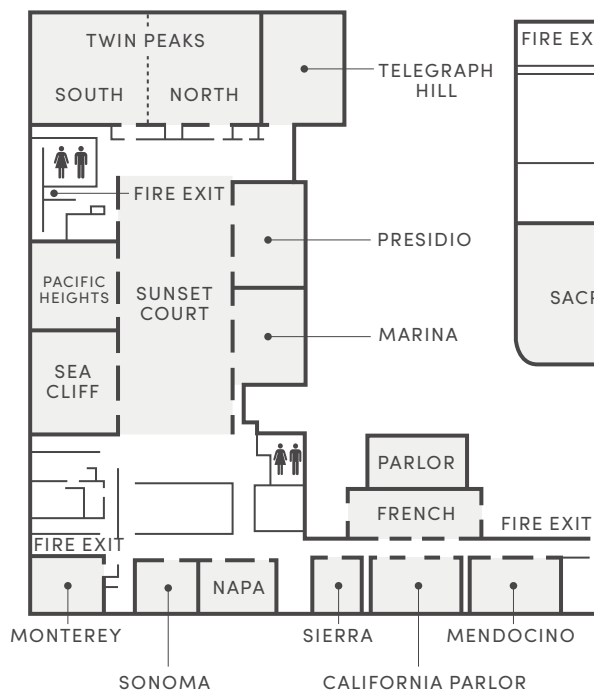

**SECOND LEVEL**

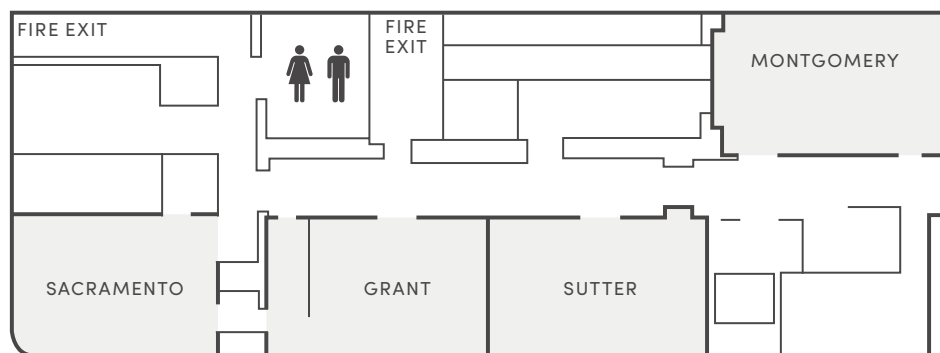

**MEZZANINE**

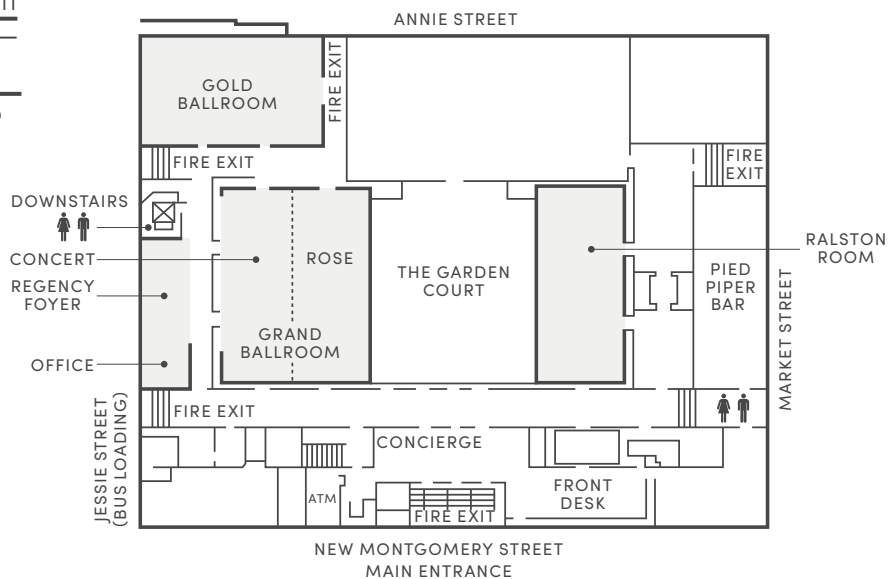

**LOBBY LEVEL**

## SUSTAINABILITY

The Palace Hotel is committed to sustainable business practices and to reducing our carbon footprint. For years, the Palace has initiated use of new and innovative systems. It is known throughout the city of San Francisco as a leader of environmental efforts – both within the hospitality industry and the local business community. In 2015 the Palace Hotel completed a multi-million dollar renovation. Several upgrades were made to reduce usage throughout the hotel. Ask us about Recology SF (landfill diversion), Make a Green Choice and the Clean the World Program.

## TRANSPORTATION

The Palace is approximately 15 miles or 30 minutes from the San Francisco International Airport (SFO). Air travelers may use shuttle service to get to the hotel at a cost of \$16.00 per person, one-way. Cab fares are approximately \$45.00 from the airport. The Bay Area Rapid Transport (BART) and streetcars (MUNI) also stop directly in front of the hotel at the Montgomery Station.

## PRESERVING AN ICON

The owners and ambassadors of the Palace Hotel are dedicated to preserving our landmark hotel. Upgrades and improvements are made on an ongoing basis to keep the Palace worthy of her name. Recent upgrades to meeting space include beautiful European carpeting in the Mezzanine and Sunset Court areas, new stylish, comfortable banquet chairs and the addition of a top-of-the-line amplified sound system. A smart dimmer lighting system has been installed throughout the hotel for energy efficiency. Millions of dollars are spent each year to properly care for this historic hotel and to maintain our level of excellence. Careful consideration is given to keeping the Palace current. We are committed to providing the luxury services, accommodations, and amenities for our guests.

A recent renovation to the guest rooms, meeting space, fitness center, indoor swimming pool, lobby, promenade, The Garden Court and GC Lounge unveiled a beautiful hotel that is the perfect balance of past and present.

## ACCOMMODATIONS

Our 556 guest rooms and 53 suites capture the feel of a chic, private residence in beautiful downtown San Francisco. Rooms feature eleven-foot ceilings and expansive windows, authentic one-of-a-kind details restored to perfection and custom contemporary elements exclusively designed for the Palace.

Each of our 53 suites offers guests the opportunity to escape from the excitement of the city and enter their own private oasis. Ranging from 17 Junior Suites to 10 one-bedroom Superior Suites, 16 one-bedroom Deluxe Suites; 6 one-bedroom Palace Suites, 3 one-bedroom Specialty Suites and most notably the one-bedroom Presidential Suite where guests truly feel like royalty.

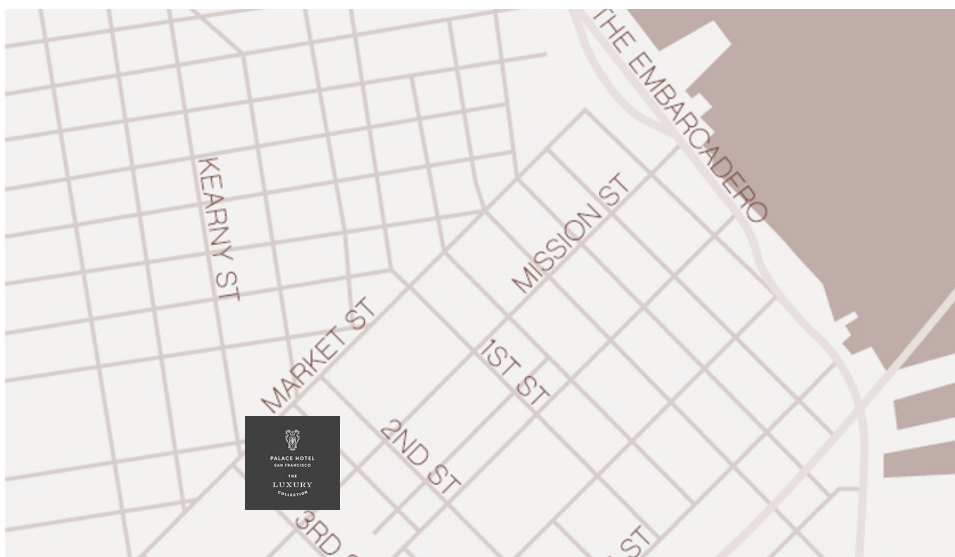

## CUISINE AND ENTERTAINMENT

The Palace has a talented and creative Catering/Conference Services staff to design and produce special banquet and theme oriented functions. In addition, we have three outstanding dining options, each offering a variety of cuisines to fit every taste.

**THE GARDEN COURT**-- Recognized as one of the world's most beautiful dining rooms. The Garden Court features a stained glass dome ceiling. As sunlight illuminates the dome, one feels as if they are sitting in a garden atrium, albeit one with elegant chandeliers, lush greenery and towering marble columns. Open for breakfast, lunch, Saturday afternoon tea and Sunday brunch, the featured style is California Cuisine.

Garden Court Hours of Operation:

Breakfast

Monday – Saturday: 6:30 am to 10:30 am

Sunday: 7:00 am to 10:30 am

Sunday City Brunch 12 Noon to 2:00 pm

Lunch Monday – Friday: 11:30 am to 1:30 pm

Saturday: 12 Noon to 1:30 pm

Signature Tea

Saturdays Only 2:00 pm to 4:30 pm: Reservations preferred.

**GC LOUNGE:**

Tea Time Monday – Saturday: 2:00 pm to 5:00 pm

Evenings in GC Lounge

Join us for Evenings in GC Lounge, as we celebrate the newly opened evening venue for cocktails, food, and conversation in our gorgeous dining room. Come and taste the flavors of San Francisco with our seasonal menu and savory bites that are accompanied perfectly by our signature cocktails, curated wines, and beer.

Monday – Sunday

5:00 pm to 9:00 pm Evenings

Weekends in GC Lounge

Saturday & Sunday: 9:00 am–2:00 pm

**PIED PIPER BAR & GRILL** – Named after the famous Maxfield Parrish painting that graces this handsome room, the Pied Piper Bar & Grill is warm and inviting. With its beautiful mosaic tile floor and rich wood paneling the Pied Piper Bar & Grill is the perfect place for comfortable, relaxed dining. Enjoy Classic California fare featuring a wonderful selection of wine, beer, traditional favorites and signature Palace cocktails.

Pied Piper Hours of Operation:

Daily: 4:00 pm to Midnight

Dinner: 4:00 pm–11:00 pm

**IN ROOM DINING** – Featuring menu items from both of our award-winning restaurants, our in-room dining menu has something for everyone to enjoy. Start your day with a balanced breakfast, or indulge in savory late night snacks. Our in-room dining menu is available 24 hours. Order by using our in-room menu or our menus available on your guestroom TV; your meal is simply a call away.